

IATESTA
STUDIO



BRUNSWICK CABINET - SIZE II

33-0809-II
72"W x 22"D x 116"H

IATESTA STUDIO

FURNITURE
LIGHTING
ACCESSORIES
TEXTILES



CUSTOM SUGGESTIONS

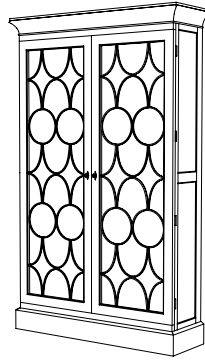

Standard

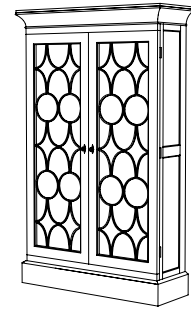

Standard Size I

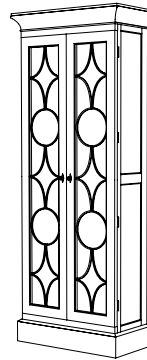

Narrower

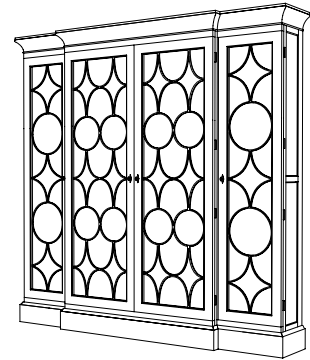

As a breakfront

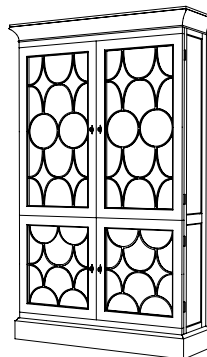

With split doors

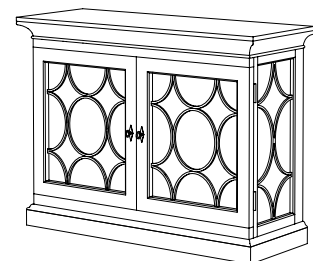

Standard Brunswick Sideboard - Size I

BRUNSWICK CABINET - SIZE II

33-0809-II

72"W x 22"D x 116"H

Species: Ash

Finish: A201 / Driftwood

Interior Finish: Contrast Lacquer

Doors: Metal Mullions over Restoration Glass

Interior Lighting

Two fixed shelves, three adjustable shelves, two drawers

Piece made to go against a wall

Built in one piece

Custom sizes and finishes available

Hand Made in Maryland
410.604.0360 (P)
410.604.0363 (F)
info@iatestastudio.com
iatestastudio.com

NOTE: Due to variations in printing, the colors shown here cannot absolutely represent true quality and hue. Prior to ordering, please confirm details of this tearsheet and reference finish samples available through your local showroom or sales representative. Line drawings are not drawn to scale.

